

C323 MOSAIC INKY

COLOR MIXING - TUNABLE WHITE

MANUFACTURED IN THE UNITED STATES - IBEW

PRODUCT LISTED
BY A NATIONALLY
RECOGNIZED
TESTING
LABORATORY



The Mosaic Inky features tunable color with a high CRI output. It also features tunable white from 1800K - 6500K. Rich blues, ambers, reds, violets and greens can be added in gradients or can completely saturate the output of the light. Interchangeable reflectors allow beam angles between 10° and 60°. This fixture is perfect for retail applications such as car dealerships and clothing stores but is equally well suited for illuminating artwork or using it in an archtainment setting.

FEATURES

- 2000 Lumen Output
- 5 DMX Channels
- Color Tuning: RGB+ Intensity+ CCT
- Tunable range: 1800K-6500K tunable white
- 84 - 95 CRI
- Dimmable from 100 - 0.1% at constant CCT
- <2 MacAdam ellipse over 50,000 hour life

POWER

- Power Consumption: 31W
- Max. Operating Temp: 104°F (40°C) ambient
- 90 - 305 VAC, 50/60 Hz
- Do not install on a circuit containing a dimmer.
- DMX Addressing is RDM-only.

OPTICS

- 10°, 20°, 40° or 60° field-changeable reflectors

WEIGHT

- 2 lbs.

CALIBRATED CCT SPECIFICATIONS

CCT [K]	TYPICAL CRI
1800 (min)	90
2700	93
3000	95
3500	95
4000	93
6500 (max)	84

EMITTER 5-YEAR WARRANTY

The warranty on the LED Emitter used in this Times Square Lighting product shall have a five year warranty from the date of purchase.

C323 MOSAIC INKY

COLOR MIXING - TUNABLE WHITE

MANUFACTURED IN THE UNITED STATES - IBEW

PRODUCT LISTED
BY A NATIONALLY
RECOGNIZED
TESTING
LABORATORY

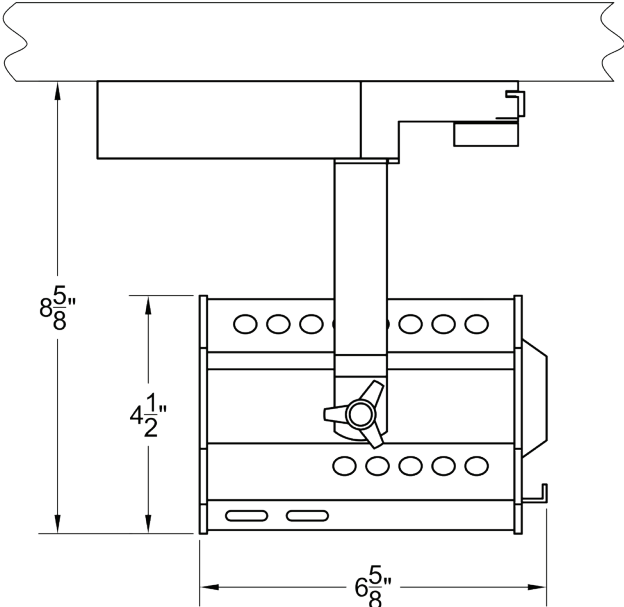
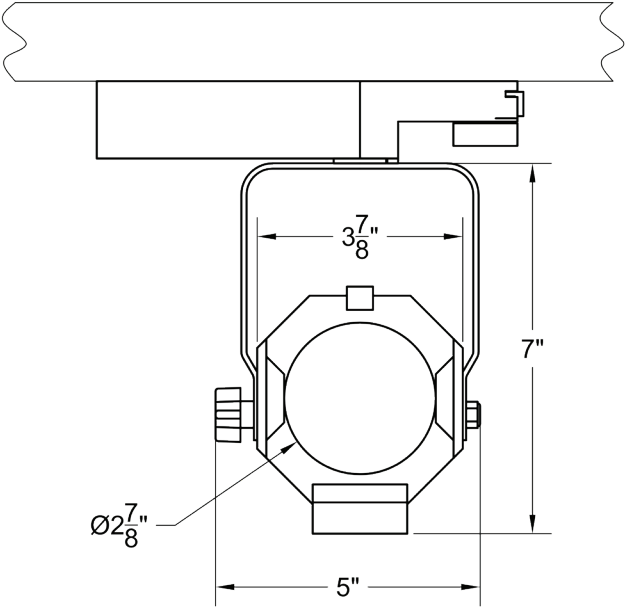

PHOTOMETRIC DATA

10° Spot Reflector

Distance	Beam Spread	Footcandles
5'	0.8'	290
7.5'	1.3'	129
10'	1.8'	73
12.5'	2.2'	46

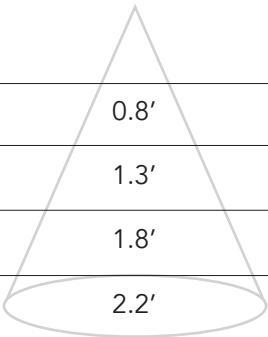

20° Spot Reflector

Distance	Beam Spread	Footcandles
5'	1.7'	240
7.5'	2.7'	107
10'	3.6'	60
12.5'	4.4'	38

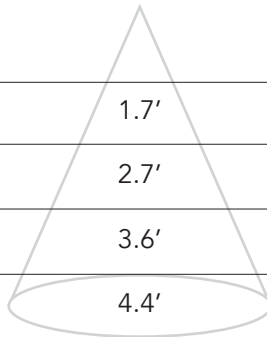

40° Spot Reflector

Distance	Beam Spread	Footcandles
5'	3.6'	140
7.5'	5.5'	62
10'	7.3'	35
12.5'	9.1'	22

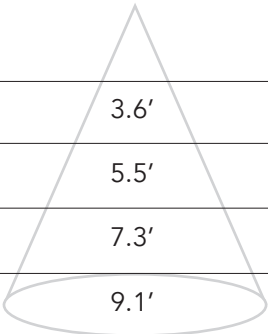

60° Spot Reflector

Distance	Beam Spread	Footcandles
5'	5.7'	80
7.5'	8.7'	36
10'	11.6'	20
12.5'	14.4'	13

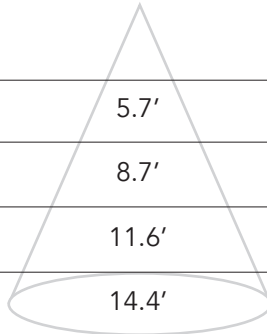

C323 MOSAIC INKY

COLOR MIXING - TUNABLE WHITE

MANUFACTURED IN THE UNITED STATES - IBEW

PRODUCT LISTED
BY A NATIONALLY
RECOGNIZED
TESTING
LABORATORY



MOUNTING OPTIONS

N8: for DT2 2-circuit track adapter for SpecTrac databus, 120V.

N9: for HDT2 2-circuit track adapter for SpecTrac databus, 227V.

NOTES ON DIMMING

Visit tslight.com/resources or scan the QR Code.



ACCESSORIES

BD20	Barndoor
LV22	Full Size Louver
XL22	Full Size X Baffle Louver
XH22	Full Size X Baffle Hood
HD22	Hood/Snoot
X00517	Accessory Holder
LV18*	Honeycomb Louver
OF22-9101*	Smoothing Frost Filter
GF22-600*	5 x 50 Linear Lens
GF22-601*	Solite Softner
GF22-673*	50 x 50 Spread Lens
SC024	Safety Cable

* X00517 Required
Not compatible with 10° reflector option.

EXTENSION WANDS

SP 12	12" Stem
SP 18	18" Stem
SP 24	24" Stem
SP X	Custom Length

SPECIFY:

MODEL	FINISH	OPTICS
C323	B = Black W = White S = Silver CC = Custom Color	10 = 10° Degree 20 = 20° Degree 40 = 40° Degree 60 = 60° Degree
MOUNTING OPTIONS		DIMMING
See Mounting Options for Ordering Codes		DX = DMX / RDM

ORDERING INFORMATION

PROJECT:	
LOCATION:	
QUANTITY:	
CONTACT:	
PHONE:	
EMAIL:	

EXAMPLE: C323-B-60-N8-DX

MODEL	FINISH	OPTICS	MOUNTING OPTIONS	DIMMING
C323				