

# PRISM PAR 7

7 X 12 RGBAW+UV LED STAGE WASH



A new addition to our Prism Par family, the Prism Par 7 provides tremendous punch in a small package. This 6-in-1 7x12 Watt LED fixture features a 25° beam angle and a dual yoke/floor stand, multiple unit power linking in rugged die-cast aluminum housing.

## FEATURES

- 7 x 12W 6-in-1 RGBAW+UV LEDs, 100,000 hours
- Natural convection cooled, totally silent operation
- Variable electronic dimmer strobe
- Built-in color & chase macros via DMX
- Built-in auto programs & sound active in standalone and M/S
- Color mixing ability in standalone mode
- 25° beam angle
- User selectable 6/10-channel DMX modes
- 3-pin male input and 3-pin female output

## WEIGHT & DIMENSIONS

- Dimensions: 6.9" x 8.9" x 8.1"
- Weight: 5.7 lbs.

## OPTICS

- 7 x 12W 6-in-1 RGBAW+UV
- 25° beam angle

## POWER

- Voltage: 100-264VAC, 47-63 Hertz
- Power Consumption: 84W
- PowerCon In / Out

## CONTROL

- Protocol: USITT DMX-512
- DMX Channels: 6/10
- Input: 3-pin XLR Male
- Output: 3-pin XLR Female
- Standalone, Master/Slave, Sound Active
- Color Preset

## MOUNTING OPTIONS

MNB	Clamp for pipe up to 2" OD
CM4	Canopy for mounting to J-box
US1	Unistrut mount
DT2	Track adapter (2 Required)

## ACCESSORIES

WINT-DMX	DMX transmitter 1000 ft. range (line of sight)
WINR-DMX	DMX receiver 1000 ft. range (line of sight)
AH7	Accessory Holder
7S	Hood
BD11	Barndoor
7CF	Spread Lens
SC-B	Safety Cable

# PRISM PAR 7

7 X 12 RGBAW+UV LED STAGE WASH

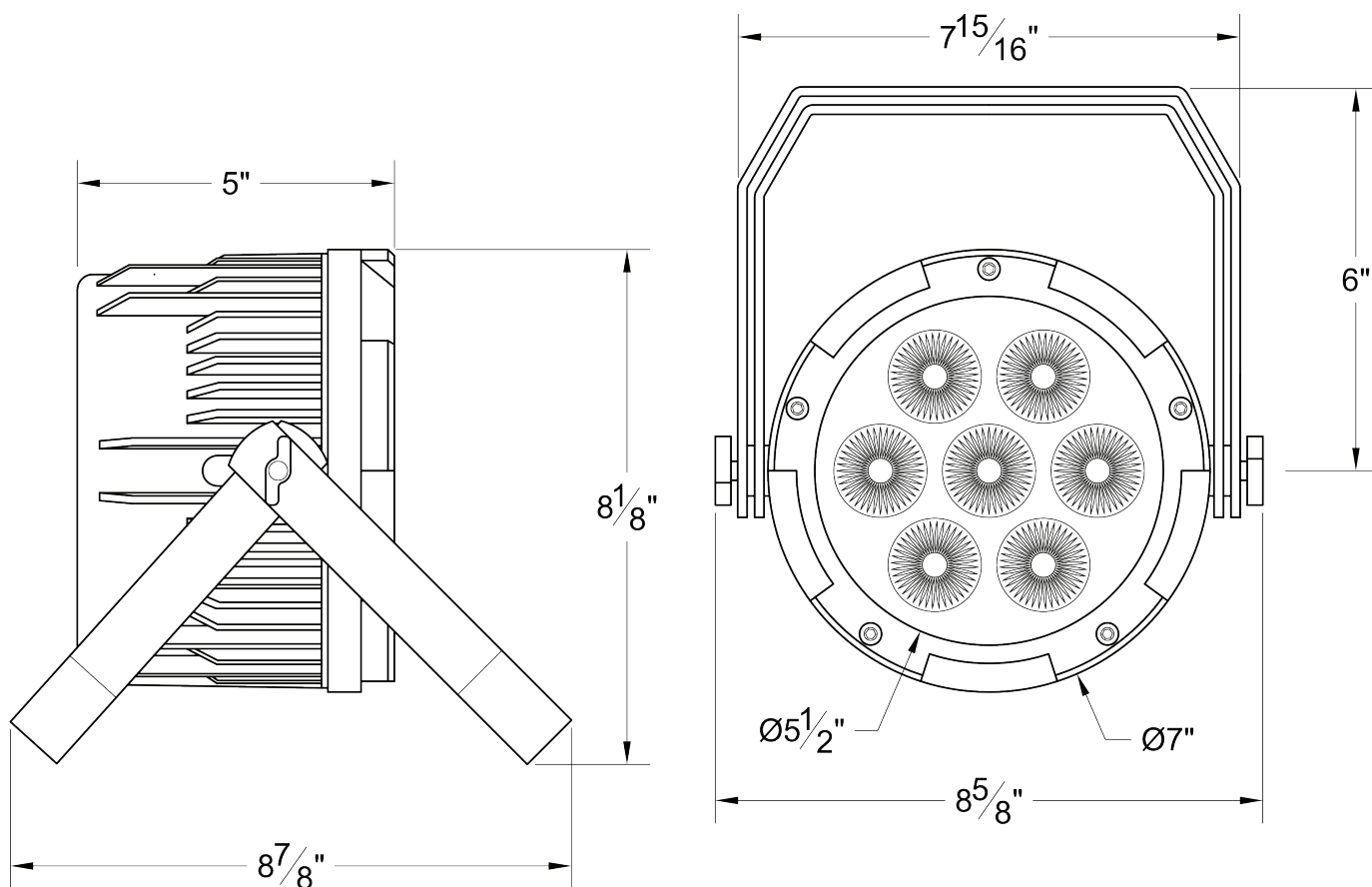

## ORDERING INFORMATION

PROJECT:	
LOCATION:	
QUANTITY:	
CONTACT:	
PHONE:	
EMAIL:	