

TLO010 BELMONT

6° NARROW BEAM



The Belmont 6° track head is a stylish and compact LED fixture that is ideal for museums, restaurants and store windows. The optical accessory kit allows you to alter the beam spreads from square, oval, rectangular and diffused within seconds. The integrated driver gives this unit a nice clean look at the ceiling line.

FEATURES

- Stylish and compact design with integrated driver.
- Very narrow beam 6° with quality light distribution.
- Simply adding optical accessories, the light shape can be changed to a square, rectangle, or a linear.
- Privately-designed joints can hold the lights at any positions without malfunctions.
- 360°+ rotation without dead angle and 90° vertical aiming.

CONSTRUCTION

- Aluminum housing with black, white, or silver finish
- Weight: 2 lbs.

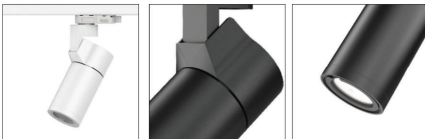

Compact design with clean and sleek appearance.

Very reliable joint.

Variety of optical accessories.

SPECIFICATIONS

- 100V - 120V
- 10-Watt
- 425 Lumens
- 3000K
- Phase Dimming
- 6° Beam Angle
- -20° - 45° C Operating Temperature Range

TLO-AC12 OPTICAL FILTER SET

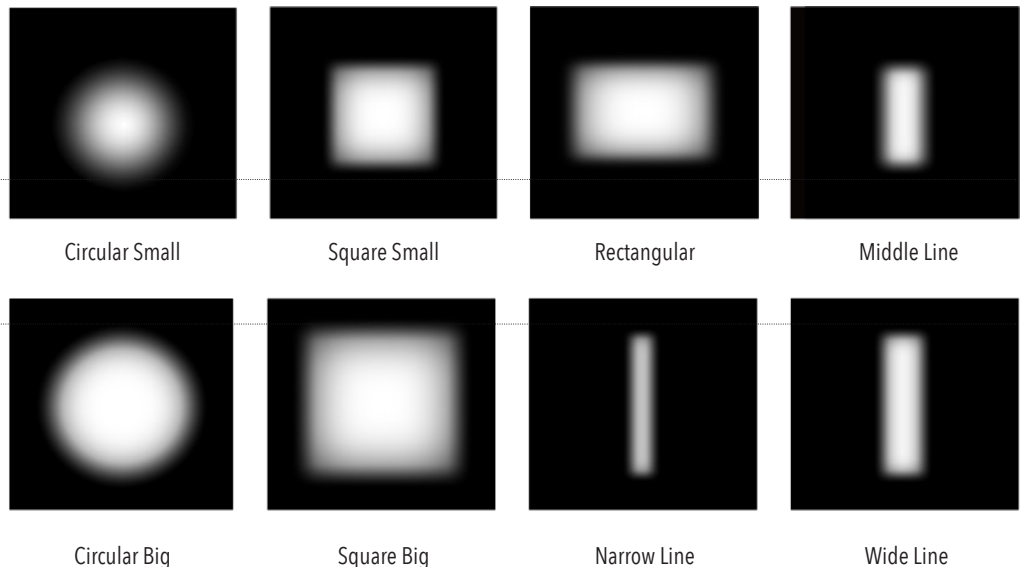

TLO010 BELMONT

6° NARROW BEAM

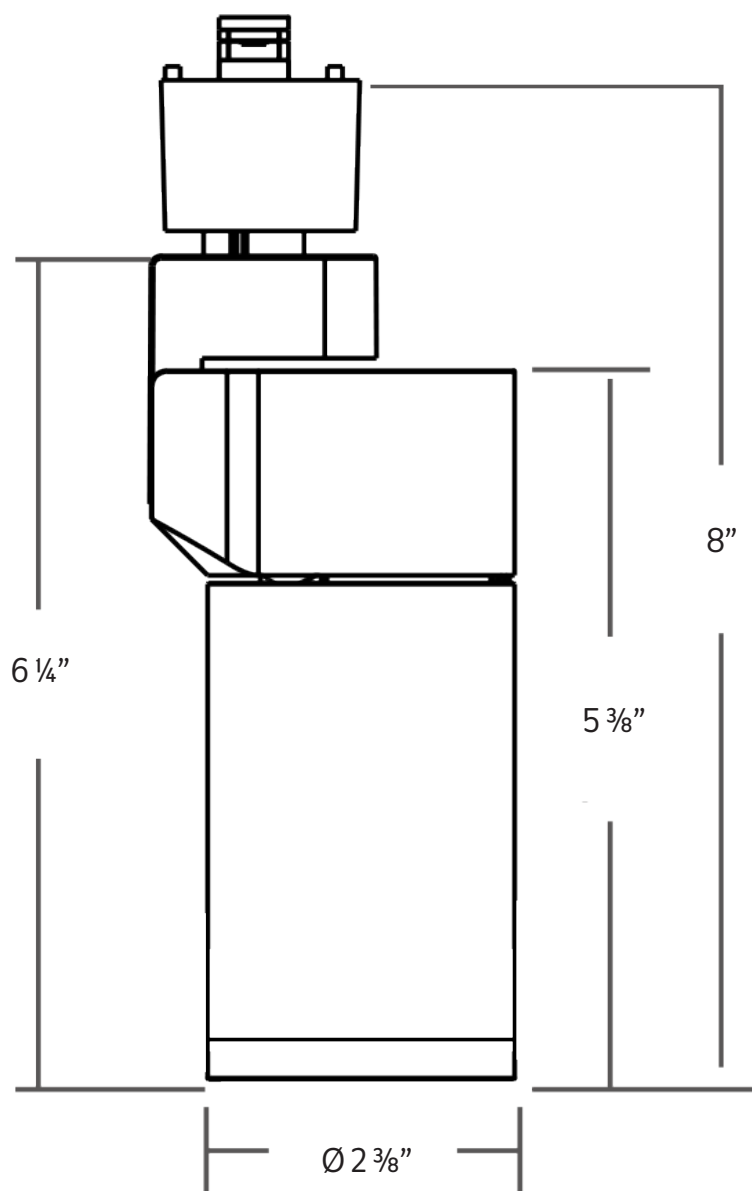

3-PIN TRACK ADAPTOR

PHOTOMETRIC DATA

Distance	Beam Spread	Footcandles
5'	6.5"	540
10'	13"	135
15'	19.5"	60
20'	26"	34
25'	32.5"	22
30'	39"	15

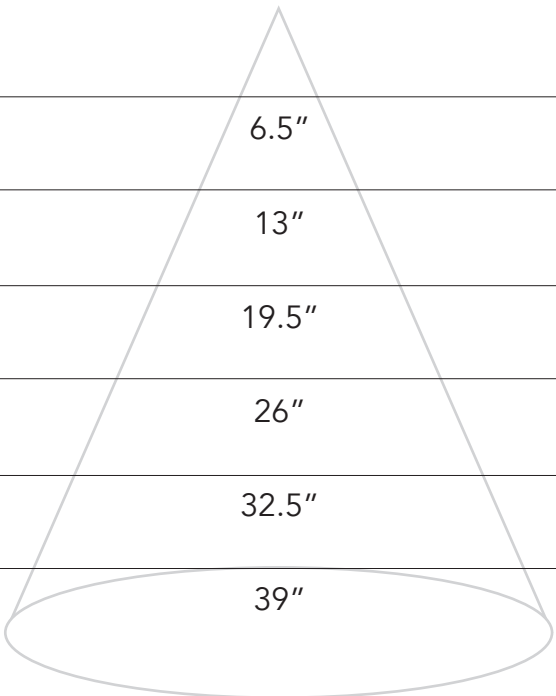

TLO010 BELMONT

6° NARROW BEAM

MOUNTING OPTIONS

AD1 Track adapter for commercial grade 1-Circuit track. This adapter is "H" and Times Square compatible. 120V.

AD1-2 Track adapter for commercial grade 1-Circuit track. This adapter is "J" compatible. 120V.

AD1-4 Track adapter for commercial grade 1-Circuit track. This adapter is "L" compatible. 120V.

DT2 Track adapter for SpecTrack 2-Circuit data track. 120V.

TA2 Track adapter for G-Series specification grade 2-circuit track. 120V.

TA3 Track adapter for G-Series specification grade 3-circuit track. 120V.

L020 Monopoint

NOTES ON DIMMING

Visit tslight.com/resources or scan the QR Code.



SPECIFY:

MODEL	FINISH	MOUNTING OPTIONS
TLO010	B = Black W = White S = Silver	See Mounting Options for Ordering Codes

Maximum Ambient Temperature: 35°C
Maximum Operating Angle: 45° from vertical

ORDERING INFORMATION

PROJECT:	
LOCATION:	
QUANTITY:	
CONTACT:	
PHONE:	
EMAIL:	

EXAMPLE: TLO010-B-AD1

MODEL	FINISH	MOUNTING OPTIONS
TLO010		