

P20

PAR20 LED CUBE

MANUFACTURED IN THE UNITED STATES - IBEW



PRODUCT LISTED
BY A NATIONALLY
RECOGNIZED
TESTING
LABORATORY



The P20 features an adjustable head and an external accessory holder that accepts louvers, barndoors, hoods and a variety of filters. Available in standard black, white and silver finishes. Custom colors are available by request and at an additional charge.

By utilizing Soraa's Snap System, unlimited possibilities for customizing this fixture are available. Options include the ability to field change the beam angle (Beam Spreader Snap), color temperature (CTO Snap), or to add a louver. Color Snaps can be used to produce brilliant hues of any color that Rosco or Lee offer.

FEATURES

- Accepts PAR16 and PAR20 lamps and LEDs
- Numerous mounting options and accessories
- Weight: 1.8 lbs

LAMP TYPE	CCT	WATTS	CRI	LUMENS
Vivid	2700K	11	95	500
Vivid	3000K	11	95	540
Brilliant	2700K	8.5	92	700
Brilliant	3000K	8.5	92	730

SNAP ACCESSORIES

00325	25° Beam Spreader Snap
00327	36° Beam Spreader Snap
00329	60° Beam Spreader Snap
00331	10°-25° Linear Snap
00333	10°-36° Linear Snap
03259	10°-60° Linear Snap
00335	25° x 25° Flat Top Snap
00337	36° x 36° Flat Top Snap
00339	40° Cutoff Louver
00325	20° Maximum Deflection Snap
00323	1/4 Color Temperature Shift Snap
0032	1/2 Color Temperature Shift Snap
00319	3/4 Color Temperature Shift Snap
03281	Enhance Snap
02183-C	Color Snap (Specify Color)

EXTENSION WANDS

SP 12	12" Stem
SP 18	18" Stem
SP 24	24" Stem
SP X	Custom Length

P20

PAR20 LED CUBE

MANUFACTURED IN THE UNITED STATES - IBEW



PRODUCT LISTED
BY A NATIONALLY
RECOGNIZED
TESTING
LABORATORY

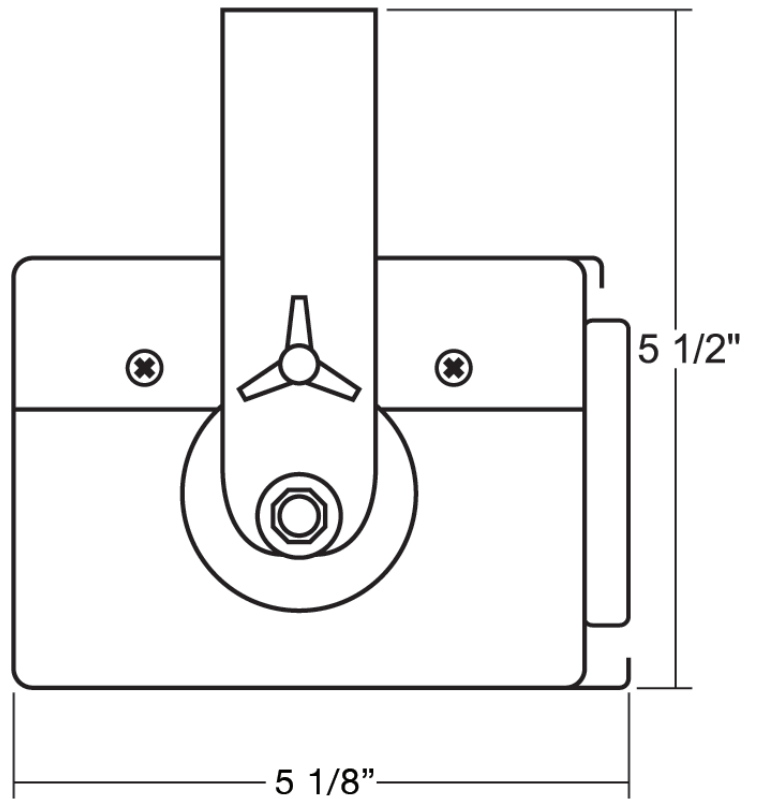
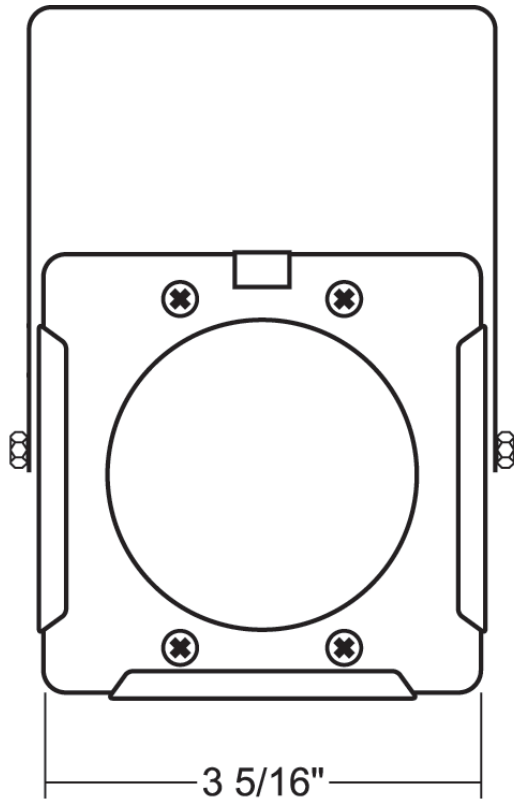

PHOTOMETRIC DATA

* Beam spread calculated based on field diameter.

10° Degree Beam

Distance	Beam Spread	Footcandles
3'	1.1'	1269
6'	2.1'	309
9'	3.2'	132
12'	4.2'	77
15'	5.3'	44

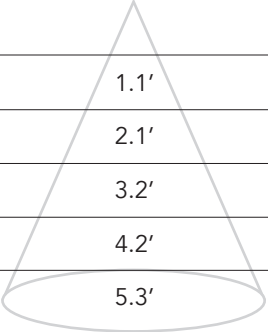

25° Degree Beam

Distance	Beam Spread	Footcandles
3'	2.2'	400
6'	4.4'	102
9'	6.6'	44
12'	8.7'	25
15'	10.9'	15

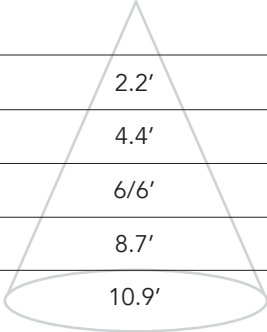

36° Degree Beam

Distance	Beam Spread	Footcandles
3'	3.5'	189
6'	6.9'	48
9'	10.4'	44
12'	13.9'	25
15'	17.3'	15

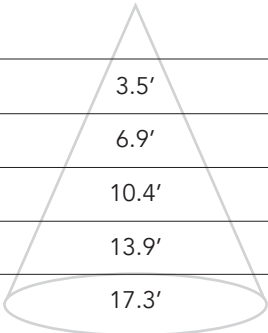

60° Degree Beam

Distance	Beam Spread	Footcandles
3'	6'	81
6'	12'	21
9'	18'	9
12'	24'	5
15'	30'	3

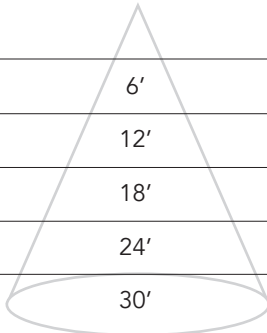

P20

PAR20 LED CUBE

MANUFACTURED IN THE UNITED STATES - IBEW



PRODUCT LISTED
BY A NATIONALLY
RECOGNIZED
TESTING
LABORATORY

MOUNTING OPTIONS

AD1 Track Adapter for commercial grade 1-circuit track. 120V. For use with lightweight fixtures.

TA2 Track adapter for G-Series specification grade 2-circuit track.

TA3 Track adapter for G-Series specification grade 3-circuit track.

US1 Unistrut adapter.

CM1 Low profile canopy for permanent mounting on standard 4" electrical boxes.

MC Medium duty pipe clamp for pipes up to 1 1/2" O.D.

MN Medium duty pipe clamp for pipes up to 2" O.D.

FIXTURE ACCESSORIES

BD4	Barndoor
LV4	Full Size Louver
HD4	Hood/Snoot
CC18	Coil Cord Option
SC-24	Safety Cable
CF4	Color Frame
GF4	Glass Color Filter
DF4	Dichroic Color Filter
GF4-600	5°x 50° Linear Lens
GF4-601	Beam Softener
GF4-673	50°x 50° Spread Lens

NOTES ON DIMMING

Visit tslight.com/resources or scan the QR Code.



SPECIFY:

MODEL	CRI	COLOR TEMPERATURE
P20	95 92	27 = 2700K 30 = 3000K
FINISH	MOUNTING OPTIONS	ACCESSORIES
B = Black W = White S = Silver CC = Custom Color	See Mounting Optios for Ordering Codes	See Accessory Options for Ordering Codes

* All fixtures sold with 10° beam angle lamps – use Beam Spreaders to achieve desired angle.

ORDERING INFORMATION

PROJECT:	
LOCATION:	
QUANTITY:	
CONTACT:	
PHONE:	
EMAIL:	

EXAMPLE: P20-9527-B-AD1-LV3

MODEL	CRI	COLOR TEMPERATURE	FINISH	MOUNTING	ACCESSORIES
P20					