

ACR 900 - 2000

CREE LED

MANUFACTURED IN THE UNITED STATES - IBEW



PRODUCT LISTED
BY A NATIONALLY
RECOGNIZED
TESTING
LABORATORY



The ACR Series emphasizes efficiency and economy and boasts the highest lumens per watt rating of any Times Square Lighting fixture to date. It is designed for a short to medium throw applications. The ACR Series can be fitted with up to three accessories, including barn doors, louvers and lenses. This versatile fixture is available with a wide variety of mounting and dimming options, allowing for a huge range of customization possibilities.

The ACR Series is available in standard black, white, or silver finishes. Custom colors are available upon request.

LED

- Cree XLamp LED array
- Color Temperature Options: 2700K, 3000K, 3500K, 4000K, 5000K, 5700K, 6500K
- CRI: 80 standard or 92 optional
- Lumen Maintenance: 90% of initial lumen output at 33,000 hours on LM-80 testing
- No UV or IR

| MODEL | CRI | TOTAL WATTAGE* | LUMENS | EFFICACY (LM/W) |
|-------|---------|----------------|-------------|-----------------|
| ACR9 | 80 / 92 | 6.37 / 6.4 | 900 / 900 | 143 / 141 |
| ACR11 | 80 / 92 | 7.7 / 8.4 | 1100 / 1100 | 143 / 131 |
| ACR13 | 80 / 92 | 8.4 / 9.5 | 1300 / 1300 | 155 / 137 |
| ACR15 | 80 / 92 | 9.7 / 11.4 | 1500 / 1500 | 155 / 132 |
| ACR18 | 80 / 92 | 11.4 / 14 | 1800 / 1800 | 158 / 128 |
| ACR20 | 80 / 92 | 13.2 / 15.8 | 2000 / 2000 | 152 / 127 |

* Total wattage equals LED plus driver. Delivered lumen may vary depending on LED module, color temperature, optics, and accessories. Testing done with 3000K LED array.

CONSTRUCTION

- Aluminum housing with black, white or silver finish
- Accepts up to 3 accessories
- Weight: 3 lbs.

ELECTRICAL

- Integral electronic driver
- 100-277V, 50/60Hz
- Meets FCC 47 CFR Part 15/18 Requirements

OPTICS | 20°, 40°, and 60° Field-Changeable Reflectors

| CBCP: | ACR9 | ACR11 | ACR13 | ACR15 | ACR18 | ACR20 |
|-------|------|-------|-------|-------|-------|-------|
| 20° | 3100 | 3875 | 4780 | 5500 | 6030 | 6700 |
| 40° | 1850 | 2275 | 2825 | 3250 | 3600 | 4000 |
| 60° | 980 | 1230 | 1525 | 1750 | 2100 | 2425 |

Testing done at 3000K, 80 CRI.

ACR 900 - 2000

CREE LED

MANUFACTURED IN THE UNITED STATES - IBEW



PRODUCT LISTED
BY A NATIONALLY
RECOGNIZED
TESTING
LABORATORY

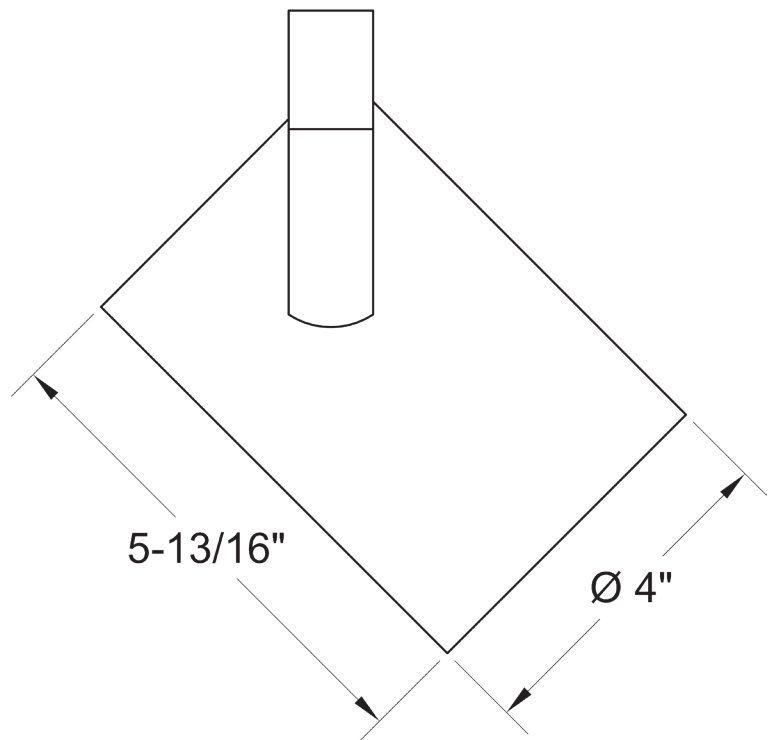
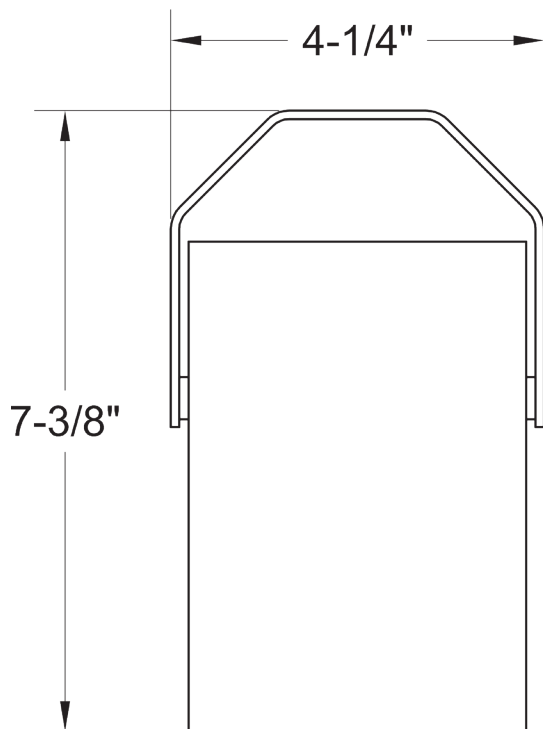

PHOTOMETRIC DATA

| Distance | 20° Spot Reflector Beam Spread | Footcandles | | | | | |
|----------|-----------------------------------|-------------|-------|-------|-------|-------|-------|
| | | ACR9 | ACR11 | ACR13 | ACR15 | ACR18 | ACR20 |
| 5' | 1'7" | 126 | 155 | 191 | 220 | 241 | 268 |
| 10' | 3'5" | 31 | 39 | 48 | 55 | 60 | 67 |
| 15' | 5'3" | 14 | 17 | 21 | 24 | 27 | 30 |
| 20' | 7'1" | 8 | 10 | 12 | 14 | 15 | 17 |
| 25' | 8'8" | 5 | 6 | 8 | 9 | 10 | 11 |
| 30' | 10'6" | - | 5 | 5 | 6 | 7 | 7 |

| Distance | 40° Medium Flood Reflector Beam Spread | Footcandles | | | | | |
|----------|---|-------------|-------|-------|-------|-------|-------|
| | | ACR9 | ACR11 | ACR13 | ACR15 | ACR18 | ACR20 |
| 5' | 3'6" | 74 | 91 | 113 | 130 | 144 | 160 |
| 10' | 7'3" | 19 | 23 | 28 | 33 | 36 | 40 |
| 15' | 10'9" | 8 | 10 | 13 | 15 | 25 | 18 |
| 20' | 14'6" | 5 | 5 | 7 | 8 | 9 | 10 |
| 25' | 18'2" | - | - | - | 5 | 6 | 6 |
| 30' | 22'2" | - | - | - | - | - | - |

| Distance | 60° Spot Reflector Beam Spread | Footcandles | | | | | |
|----------|-----------------------------------|-------------|-------|-------|-------|-------|-------|
| | | ACR9 | ACR11 | ACR13 | ACR15 | ACR18 | ACR20 |
| 5' | 5'7" | 39 | 49 | 61 | 70 | 85 | 97 |
| 10' | 11'6" | 10 | 12 | 15 | 18 | 21 | 24 |
| 15' | 17'3" | 5 | 5 | 7 | 8 | 9 | 11 |
| 20' | 23'1" | - | - | - | 5 | 5 | 6 |
| 25' | 28'9" | - | - | - | - | - | 5 |
| 30' | 35'2" | - | - | - | - | - | - |

ACR 900 - 2000

CREE LED

MANUFACTURED IN THE UNITED STATES - IBEW



PRODUCT LISTED
BY A NATIONALLY
RECOGNIZED
TESTING
LABORATORY

MOUNTING OPTIONS

DT2 2-circuit track adapter for SpecTrack databus. 120V.

HDT2 2-circuit track adapter for SpecTrack databus. 277V.

AD1 Track adapter for commercial grade 1-circuit track.
Good for use with small, lightweight fixtures.

TA2 Track adapter for G-Series specification grade
2-circuit track. 120V.

HTA2 Track adapter for G-Series specification grade
2-circuit track. 277V.

TA3 Track adapter for G-Series specification grade
3-circuit track. 120V.

CM4 Canopy Mount

US1 6-5/8" x 1-1/2" Unistrut Adapter

TB8 8" x 8" Portable table base for floor and
table use

MC Light duty pipe clamp for small fixtures.
For pipes up to 1 5/16" O.D.

MN Medium duty pipe clamp for small to large fixtures.
For pipes up to 2" O.D.

PC9M Heavy duty pipe clamp for large, heavy fixtures.
For pipes up to 2" O.D.

ACCESSORIES

| | |
|------------|------------------------------|
| BD20 | Barndoor |
| LV22 | Full Size Louver |
| XL22 | Full Size X Baffle Louver |
| XH22 | Full Size X Baffle Hood |
| HD22 | Hood/Snoot |
| X00517 | Accessory Holder |
| LV18* | Honeycomb Louver |
| FX22-26* | Red Filter |
| FX22-80* | Blue Filter |
| FX22-64* | Light Blue Filter |
| FX22-90* | Green Filter |
| FX22-21* | Amber Filter |
| FX22-10* | Yellow Filter |
| FX22-33* | Pink Filter |
| OF22-9101* | Smoothing Frost Filter |
| OF22-0S20* | 20° Beam Softener |
| OF22-1060* | Linear Spread 10 x 60 Degree |
| OF22-0S30* | Beam Soft Filter |
| OF22-0S40* | 40/60 Degree Diffusion |
| CC18 | Coil Cord Option |
| SC024 | Safety Cable |

* X00517 Required. Wide Range of Colors Available

NOTES ON DIMMING

Visit tslight.com/resources or scan the QR Code.



SPECIFY:

| MODEL | LUMENS | CRI | |
|--|--|---|--|
| ACR | 9 = 900 11 = 1100 13 = 1300 15 = 1500 18 = 1800 20 = 2000 | 80 92 | |
| COLOR TEMPERATURE | FINISH | VOLTAGE | |
| 27 = 2700K 30 = 3000K 35 = 3500K 40 = 4000K 50 = 5000K | B = Black W = White S = Silver CC = Custom Color | 100 II 120 240 277 | |
| OPTICS | MOUNTING | DIMMING † | ACCESSORIES |
| 10 = 10° 20 = 20° 25 = 25° 40 = 40° 60 = 60° ZO = 14° - 40° Zoom Optics | See Mounting Options for Ordering Codes | TE = Trailing Edge * LE = Leading Edge ** 010 = 0-10V ND = Non-Dimming | See Accessory Options for Ordering Codes |

Maximum Ambient Temperature: 35°C
Maximum Operating Angle: 45° from vertical

* 277V TE Dimming Available on 1800, 2500 & 3000 Lumen, 80 CRI and 1500 & 2700 Lumen, 92 CRI only.
** 120V Only

† See "Notes on Dimming"
‡ Non-Dim or 0-10V Dimming Only

ORDERING INFORMATION

| | |
|-----------|--|
| PROJECT: | |
| LOCATION: | |
| QUANTITY: | |
| CONTACT: | |
| PHONE: | |
| EMAIL: | |

EXAMPLE: ACR15-80-27-B-120-20-T1-TE-BD20

| MODEL | LUMENS | CRI | COLOR TEMPERATURE | FINISH | VOLTAGE | OPTICS | MOUNTING | DIMMING | ACCESSORIES |
|-------|--------|-----|-------------------|--------|---------|--------|----------|---------|-------------|
| ACR | | | | | | | | | |